

# ProFace X [P]

## Face & Palm Verification Terminal with Mask Detection



**ProFace X [P]** is a fully upgraded version of the ProFace product line, which is designed to deal with all kinds of scenarios. Powered by the ZKTeco-customized CPU for running the intellectualized engineering facial recognition algorithm and the latest computer vision technology, the ProFace X [P] supports both facial and palm verification with large capacity and rapid recognition speed, boosting the security performance in all aspects.

ProFace X [P] also helps eliminate hygiene concerns; not only because of the contactless recognition technology it is equipped with, but also because of the masked individual identification.

The facial recognition capability has reached a new height in the biometrics technology industry with a maximum of 50,000 facial templates, recognition speed of less than 0.3 sec per face, and ultimate anti-spoofing ability against almost all types of fake photos and videos attack.

In addition, the 3-in-1 palm recognition (Palm Shape, Palm Print and Palm Vein) is performed in 0.35 sec per hand; the palm data acquired will be compared with a maximum of 5,000 palm templates.

As mentioned above, the ProFace X [P] can assist in reducing the risk of infection and germs spreading during the recent global public health issue as well. It enables masked individual identification during facial and palm verification at all access points, especially in hospitals, factories, schools, commercial buildings, airports, stations, and other public areas.

# Features

- Ultra-large capacity of facial templates for 1:N verification: 30,000 (standard); max. 50,000 (optional)
  - Huge capacity of palm templates; 1:N - 5,000 palm templates
  - Anti-spoofing algorithm against print attack (laser, color and B/W photos), videos attack, and 3D mask attack
  - Intelligent energy-saving design; precisely evaluation of the distance (up to 2.5m (8.2ft)) between the user and the device by a microwave detector before waking up the recognition terminal
  - 2MP starlight CMOS sensor camera with WDR function, which enables the terminal to recognize faces under extreme lighting conditions (0.5 lux – 50,000 lux)
  - 8" touch screen with 400 lux, which offers high visibility under strong and direct light
  - IP68 dust-proof and waterproof standard & IK04 protection standard
  - Wide range of working temperature (-30 ~ 60°C; -22 ~ 140°F)
  - Mask detection; facial verification available with masks
- \* Facial verification for masked individuals will increase FAR. Palm verification for masked individuals is recommended.

# Specifications (G: GL Exclusive Feature)

<p><b>Capacity</b></p> <p>G Faces 30,000 (1:N) 50,000 (Optional)</p> <p>Palm 5,000 (1:N)</p> <p>Users / Cards 50,000</p> <p>G Transactions 1,000,000 (Optional) 2,000,000</p> <p>User Photos 10,000</p> <p>Event Photos 10,000</p> <p><b>Compatibility</b></p> <p>Security Relay Box</p> <p>Wiegand / RS485 / RS232 Slave Reader with FP / RFID / Barc ode / QR-code</p> <p>ZKBioSecurity Software</p> <p><b>Standard Functions:</b></p> <p>Access Levels, Groups, Holidays, DST, Duress Mode (Password), Anti-Passback, Record Query, Tamper Switch Alarm, Custom Wallpaper &amp; Screen Saver</p>	<p><b>Access Control Interface</b></p> <p>Lock Relay Output</p> <p>Alarm Output / Auxiliary Input</p> <p>Exit Button / Door Sensor</p> <p><b>Special Functions</b></p> <p>G IP68 &amp; IK04</p> <p>G 0.3s High Speed Facial Verification</p> <p>Liveness Detection</p> <p>HTTPS Communication Encryption (Optional)</p> <p>G Event Snapshot</p> <p><b>Hardware</b></p> <p>900MHz Dual Core Customized Computer vision CPU</p> <p>G 512MB RAM / 8G Flash</p> <p>G 8" High light (400lux) IPS Touch LCD</p> <p>125KHz EM Reader / 13.56MHz MF(Optional)</p> <p>G 2MP WDR Low Light Camera</p> <p>Adjustable Light brightness LED</p> <p>Hi-Fi Voice</p> <p>High Sensitivity Microphone</p> <p>Distance Detection Sensor</p> <p>Reset Button and Tamper Switch</p>	<p><b>Communication</b></p> <p>TCP/IP</p> <p>Wiegand Input / Output</p> <p>Wi-Fi (Optional)</p> <p>RS485 / RS232</p> <p><b>Additional Info</b></p> <p>Face Algorithm: ZKLiveFace5.8</p> <p>Palm: FAR ≤0.01%; FRR ≤1%</p> <p>Working Temperature: -30°C ~ 60°C, (-22°F ~ 140°F)</p> <p>Working Humidity: ≤93%</p> <p>Storage Temperature: -40°C ~ 65°C (-40°F ~ 149°F)</p> <p>Storage Humidity: ≤93%</p> <p>Net Weight: 853g</p> <p>Dimensions (H*L*D): 227*143*26.1mm</p> <p><b>Power</b></p> <p>Operating Voltage: 12V DC</p> <p>Current Draw: &lt; 2,000mA</p>
---	---	--

# Configuration

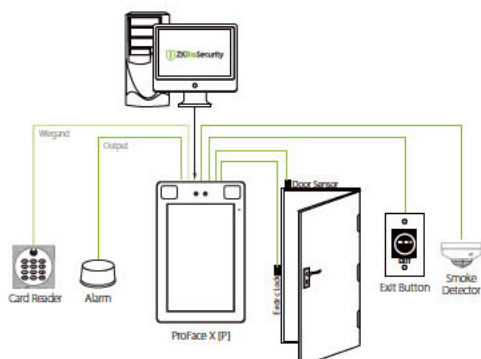

# Dimensions (mm)

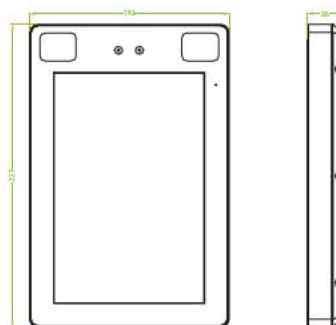

ZKTECO CO.,LTD.