

P200 & P260

Palm recognition Multi-Biometric T&A Terminal with Access Control Functions



P serial is a multibiometric identification time & attendance and access control terminal, which can connect with third party electric lock, door sensor, and exit button etc.

With the latest palm/fingerprint identification algorithm and streamlined technology, it can hold 600 palm templates and up to 10,000 fingerprint templates without dividing into groups.

Communicating via Wi-Fi , TCP/IP, and USB host, it ensures a smooth connection and data transfer. Amazing verification speed and intuitive operation process make it popular. Elaborately designed and finely processed, it matches your slap-up office perfectly.

Features



Build in PoE



1 channel auxiliary input for smoke detector connection



Build in battery, up to 4 hours



Multiple communicate mode, Wi-Fi, TCP/IP, 3G, USB host



Stable operation under strong light source



Advance access function including Lock connection, alarm, Wiegand input/output



600 Palms, 3,000 Fingerprints,
10000 Cards and 100,000 records

Specifications

Product	P200		P260
Main	Biometric	Fingerprint and Palm	
	RF Optional	125kHz EM / 13.56MHz MF	
Capacity	Max User(1:N)	10,000	
	Max Fingerprint (1:N)	3,000 standard / 10,000 Optional	
	Max Palm (1:N)	600	
Interface	TCP/IP	10/100 M	
	PoE Optional	802.3 at 28W	
	Wi-Fi	802.11 B/G/N	
	3G Optional	WCDMA	
	USB	USB 2.0 (Host)	
	RS232	1 port for external printer	
	RS485	1 port for FP reader	
	Relay	2 relays	
	Wiegand	1ch In & Out	
	Input	1 Input	
Hardware	LCD	3.0" Color LCD	
	Sound	24-bit	
	Operating Temp.	0 °C - 45 °C	
	Operating Humidity	20% ~ 80%	
	Power	DC 12V 1.5A	DC 12V 3A
	Dimensions(W x H x D mm)	213*155*107.81mm	
	Certificates	CE, FCC, RoHS	
Function	Standard	Automatic Status Switch, Self-Service Query, DST, T9 Input, 9 Digit User ID, Scheduled Bell, Photo ID Lock, sensor, Exit button	
	Optional	ID / MF, ADMS	
Compatibility	ZKTime.net 3.0, ZKAccess 3.5, BioTime 8.0		

Configuration

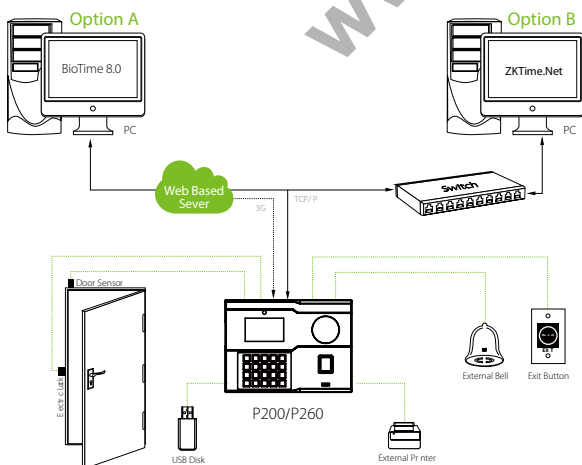

Dimensions (mm)

