

## G3 Pro

### Revolutionary 3-in-1 Contactless Palm and Facial Recognition Terminal



**G3 Pro** is powered by Computer Vision technology like 3-in-1 contactless palm recognition, which means the terminal can perform bio-authentication with a user's palm vein, palm print, and the shape of palm at the same time once the sensor detects a hand presented.

Palm vein and palm print patterns are reliable human identifiers as the details are extremely hard to be duplicated, thus, together with the powerful algorithm, users may enjoy the terminal's enhanced anti-spoofing ability.

Eliminating hygienic concerns, G3 Pro, equipped with a novel hand tracking technique allowing angle tolerance as wide as  $\pm 60^\circ$  in the roll axis, the huge capacity of 6,000 palm templates, and a 1.4GHz quad-core CPU, extracts palm print and vein pattern for analysis at a distance for recognition from 0.2m to 0.5m in less than 0.35s. Users no longer need to struggle to touch the sensor at a specific angle and align the center of the palm with the center of the input sensor for proper hand images to be acquired.

## Features



Modern Design & Interactive UI



Revolutionary SilkID  
Fingerprint Sensor



Multiple Verification Modes:  
Face / Fingerprint / Palm /  
Card / Password



Outstanding Performance With  
Dry, Wet and Rough Fingers



Simple Management & Scalability

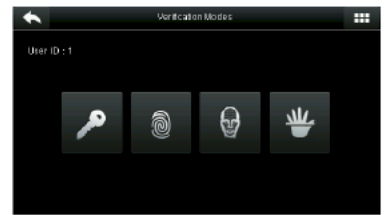
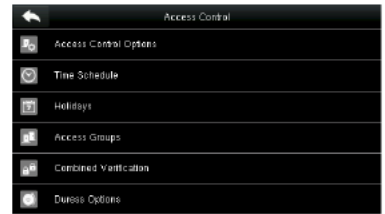

## Specifications (G: GL Exclusive Feature)

### Capacity

|              |         |
|--------------|---------|
| Fingerprints | 20,000  |
| G Faces      | 12,000  |
| G Palm       | 6,000   |
| Cards        | 20,000  |
| Transactions | 200,000 |

### Communication

TCP/IP  
USB Host  
Wiegand Output

### Access Control Interface

Lock Relay Output  
Alarm Output  
Exit Button  
Door Sensor  
External Bell

### Hardware

- G 1.4GHz Quad Core CPU
- G Memory 1G RAM / 1G Flash
- SilkID Fingerprint Sensor
- G 4.3 Inches Touch Screen
- Hi-Fi Voice & Indicator
- Tamper Switch Alarm

### Standard Functions

ID Card / Work Code / WDMS  
DST / SMS / Bell Schedule  
Attendance Status Auto-Switch  
Record Query / Photo ID  
Custom Wallpaper & Screen Saver

### Special Functions

- G Multiple Biometric Verification Modes
- G Alive Face / Palm Detection
- G Duplicate Face / Palm Detection

### Optional Functions

- HID Proxy / IC Card Reader
- Wi-Fi / 3G
- External Printer
- G Battery (2,000 mAh)
- G POE (Standard IEEE 802.3at)

### Compatibility

BioTime8.0  
ZKBioSecurity (T&A)  
WDMS

### Additional Info

Working Temperature: 0 °C ~ 45 °C  
Dimensions: 199.2 × 171.8 × 96.9 mm  
Algorithms: ZKFace v12.0 & ZKFinger v10.0 & ZKPalm V12.0  
Fingerprint: FAR≤0.0001%; FRR≤0.01%  
Face: FAR≤0.001%; FRR≤1%  
Palm: FAR≤0.01%; FRR≤1%

### Power

Operating Voltage 12V DC  
Current Draw < 500 mA

## Configuration

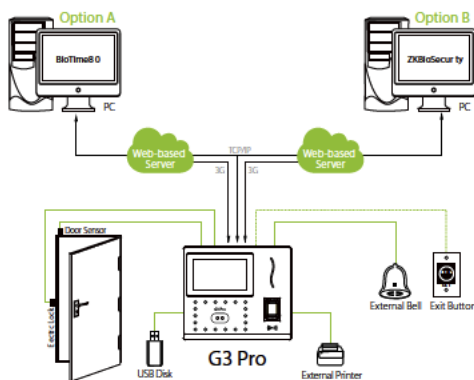

## Dimensions (mm)

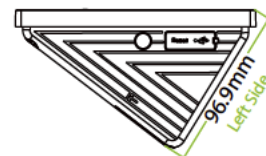
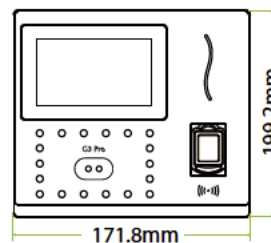

ZKTECO CO.,LTD.



Copyright©2020 ZKTECO CO., LTD. All rights reserved.

V1.0 2020.10.14